

BALLACHULISH VILLAGE HALL

Oct 2010 Mick Andrew



General Information

Address: Loan Fern, Ballachulish, Argyll PH49 4JB

<http://www.balla-hall.co.uk/>

- Venue is at east end of village near Information Centre and car park, just off main A82 road. Car park adjacent to venue.
- Built 1987 and refurbished in 2012.
- Capacity 130 if stage used, up to 100 if performing on floor. Non-interlocking plastic stacking chairs.
- Mobile reception reasonable. Payphone in foyer.
- Ballachulish has hotels, pub, Co-op, Post Office, craft shops, bank (without cashpoint) and a lot of slate. Nearest cashpoint (service charge) & petrol at Glencoe (1 mile). 'Free-use' cashpoint and other services at Fort William (14 miles).

Hall Details

- Hall Dimensions: 7.92M (26') wide x 15.42M (50'7") long. Height above approx 4.57M (15') – new false ceiling installed.
- Stage: 4.8M (15'9") wide x 2.95M (9'8") deep. Height of proscenium arch 3.35M (11'), height of stage 1.27M (4'2"). Wings 1.52M (5') both sides. Additional staging units available 4.88M (16') wide x 1.22M (4') deep. No crossover. Access treads in stage right corridor (no access to stage from hall).
- Décor: floor wood laminate with Badminton Court markings; walls wood ply lower, cream upper; roof white. FOH tabs maroon.
- Get-in: through hall foyer, 2 sets double doors straight into hall, straight, flat. Approx 20M from van loading area to stage. 1.5M (4'11") wide x 2.03M (6'8") high.

- Acoustics good.
- Blackout excellent, no windows.
- Heating by wall-mounted red-glow quartz heaters on £1 coin meter.
- Upright piano available. No smoke detectors.
- Extending ladder available.

Technical

- Power: 100amp 3-phase incomer in switch room adjacent to kitchen. 63amp 3-phase socket & 32amp single-phase socket in same place.
- Small stage lighting rig – 6 channel desk, 6 channel dimmer rack, 2 FOH side LX bars, & LX brackets on stage pros arch. 4 x 500watt profile spots, 2 300watt fresnels.
- No sound equipment seen.
- Houselights are switched roof fluorescents, switched from switch room.

Backstage

- Committee room can be used as dressing room.
- Kitchen available.
- No separate toilets. Shower available in disabled toilet.



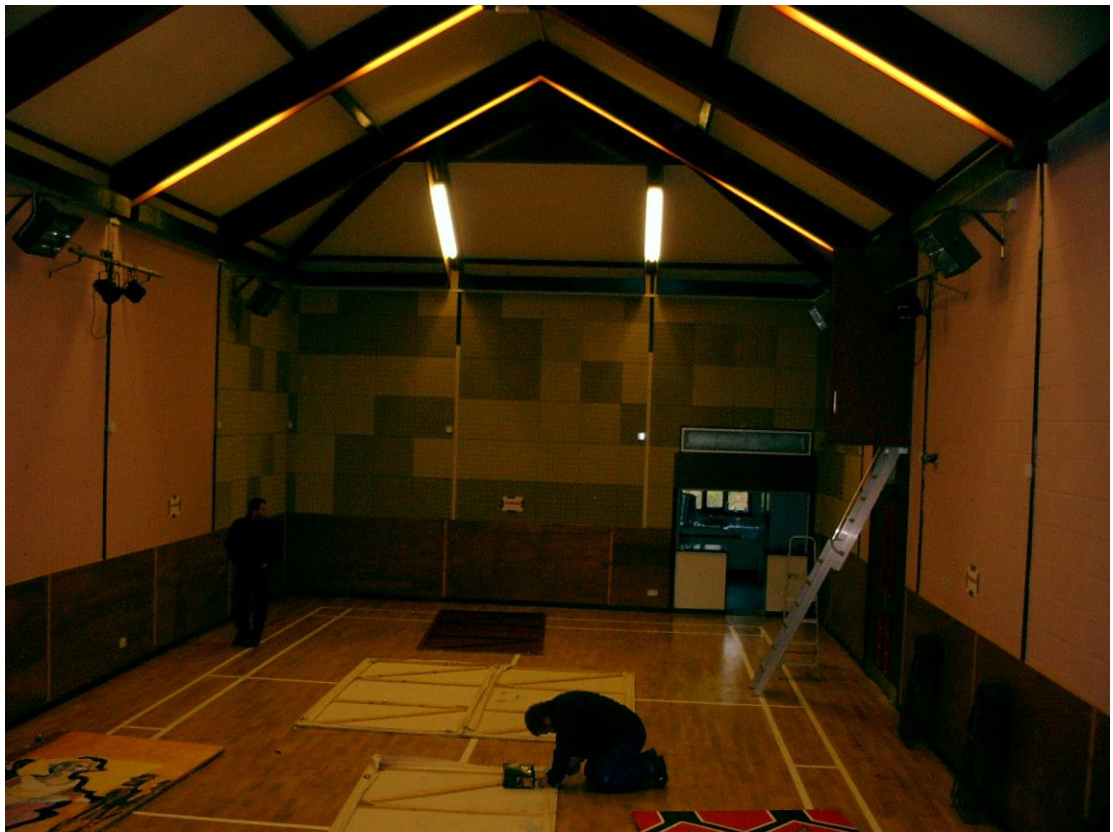

BALLACHULISH Village Hall

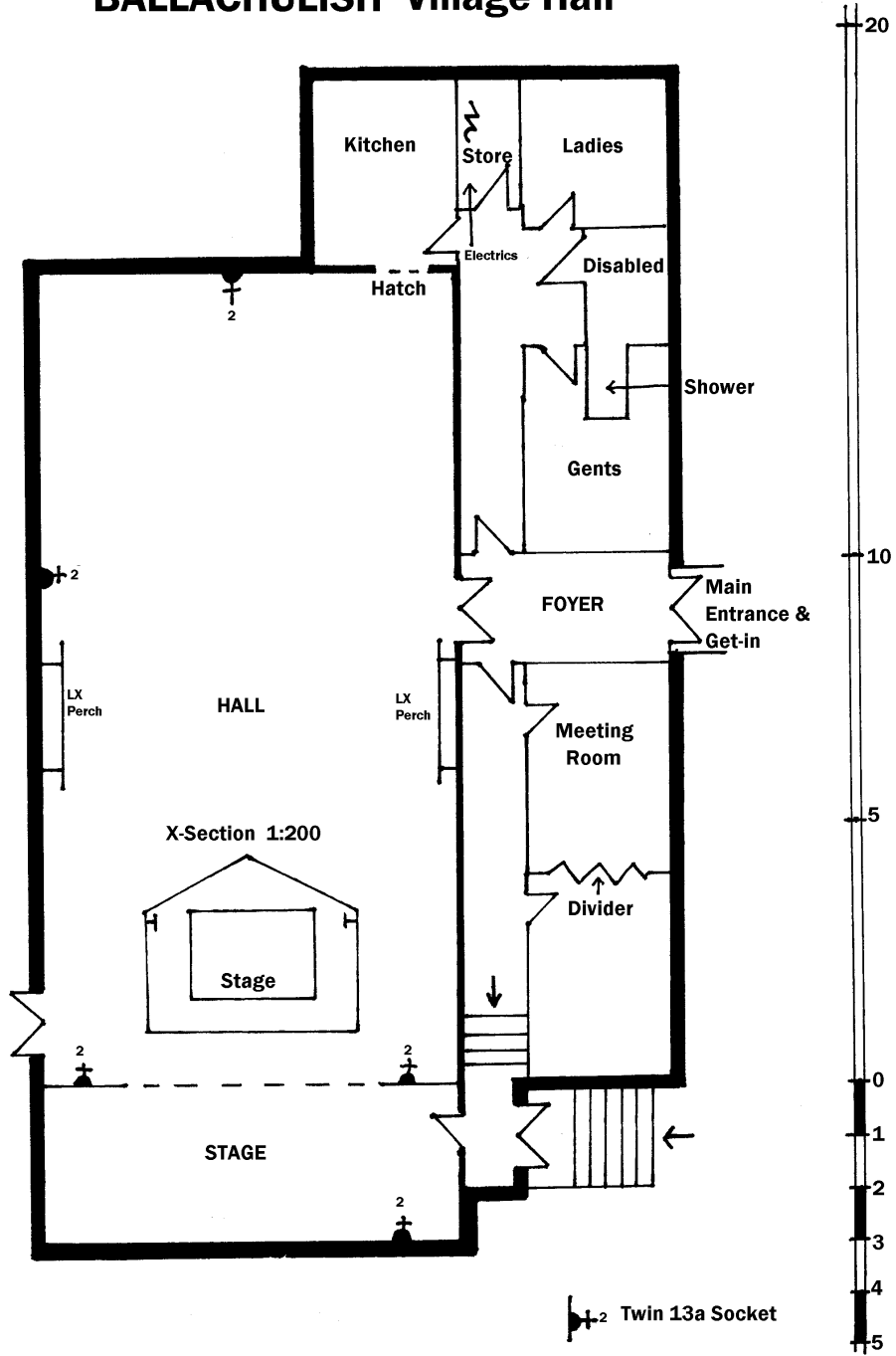

Scale 1:100 at A4
Mick Andrew 2002

