

# ARDVASAR COMMUNITY HALL, SOUTH SKYE

May 2015 Mick Andrew



## **General Information**

Address: Ardvassar, Sleat, Isle of Skye IV45 8RS

- Venue is on RHS of road into Ardvassar village just before the Hotel. Limited car parking.
- Built 1970's and renovated in 1991.
- Capacity approx 100 if performing on stage, up to 50 if performing on floor. 50 stacking padded non-interlocking chairs.
- Mobile reception reasonable.
- Ardvassar has a hotel/pub. Caf e's, Post Office, General Store and petrol at Armadale (1 mile). Banks, supermarkets and other services in Broadford (17 miles) or Kyle of Lochalsh (25 miles).

## **Hall Details**

- Hall Dimensions: 7.22M (23'8") wide x 9.6M (31'6") long. Height at side walls 2.5M (8'2") rising to 3.94M (12'11") at apex. 3 roof supports within hall reduce this slightly.
- Stage: 7.25M (23'9") wide (though access ramp DSL reduces this downstage) x 2.41M (7'11") deep. Height of stage 0.46M (1'6"). No Crossover – back rooms are private. Access ramp DSR, 2 moveable treads.
- D cor: floor purple carpeted with laminated boarded dancefloor in front of stage; walls red lower, white upper with white roof.
- Get-in: Through side fire exit (single door & ramp, straight) or through foyer up 3 steps, right angle turn, through 3 sets of double doors. 5M from van loading area to stage. Emergency exit door 0.8M (2'7") wide x 2M (6'6") high; FOH doors 1.2M (3'11") wide x 1.96M (6'5") high.
- Acoustics good.

- Blackout partial – windows have unlined curtains and side door windows have none.
- Heating by wall-mounted red-glow quartz heaters.
- Upright piano available. 2 Smoke Detectors in hall.
- No access equipment.

### **Technical**

- Power: (not seen) but assumed to be 100amp 3-phase incomer in locked store room adjacent to kitchen, hall sockets assumed to be on 32amp trip.
- No Stage lighting.
- No Sound equipment. Lights & sound equipment can be arranged via local promoter.
- Houselights are switched fluorescents, switches at USL on stage.

### **Backstage**

- Storage and Committee room backstage can be used as Dressing Rooms.
- Kitchen available.
- No separate toilets.

**nb – new double doors replace window in middle of Hall left (stage right).**





SLEAT COMMUNITY HALL, ARDVASAR, ISLE OF SKYE  
totally renovated late 1991

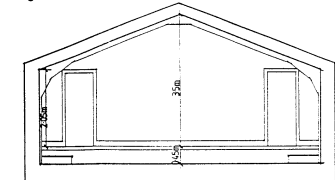
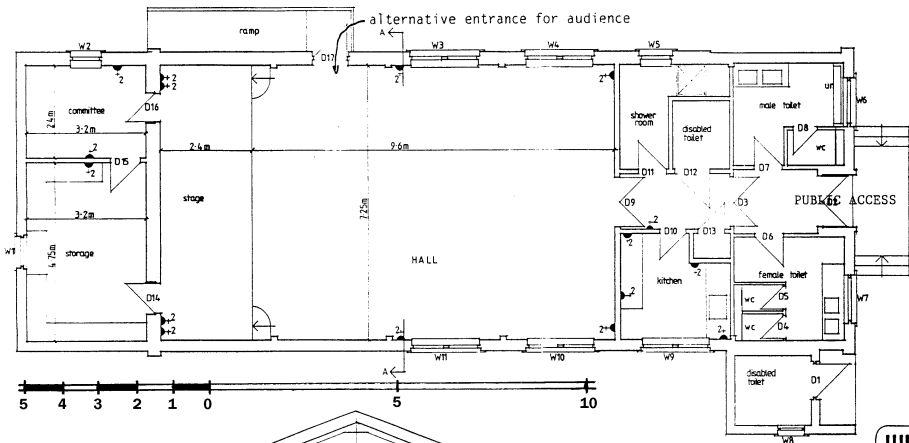

contact for arts promotions  
Duncan MacInnes  
SEALL  
Ostaig House, Sleat, Isle of Skye  
IV44 8RQ Tel 01471.844207  
SEALL is the community events group

**WITTETS** ARCHITECTS  
REGISTERED ARCHITECTS BY THE RIBA  
1000 GLENVIEW AVENUE, ST. ALBANS, HERTS. AL3 4EJ  
01438 750000

PROJECT TITLE  
Sleat Community Hall

SCALE DATE DRAWN BY

SEALL has access to about 10 spots/floors and small dimmer unit.

