

Dunoon Burgh Hall

DBH Tech Spec Feb 2018

Dunoon Burgh Hall Trust

195 Argyll Street

Dunoon

PA23 7DD

Tel: 01369 701776

Email: info@dunoonburghhall.org.uk

Web: <https://www.dunoonburghhall.org.uk/>

The recently re-opened Dunoon Burgh Hall (DBH) provides a fantastic cultural focal point for the Cowal community and its many visitors. Following a £1.6million refurbishment project, the Hall is now home to art galleries, creative workshop spaces, meeting rooms and a beautiful traditional main hall fully equipped for 21st Century uses. With full disabled access and a bright new Café, Dunoon Burgh Hall offers a warm welcome to all.

Saved from demolition by the determination of the community, the restoration of Dunoon Burgh Hall is an inspiring story of a small Scottish community coming together to preserve part of its heritage. In the process, that community has created an inclusive, arts-led hub where like-minded people can meet, share new ideas and bring these ideas to life. Enter Dunoon Burgh Hall and you're right in the heart of the community

As a Scottish charity, Dunoon Burgh Hall Trust aims to engage, inspire and challenge people of all ages by encouraging participation in art, music, drama, dance, festivals and much more. Our innovative programme of theatre, music and art **Brings the unexpected to Dunoon**

1st Floor plan inc stage with extension and basic seating lay-

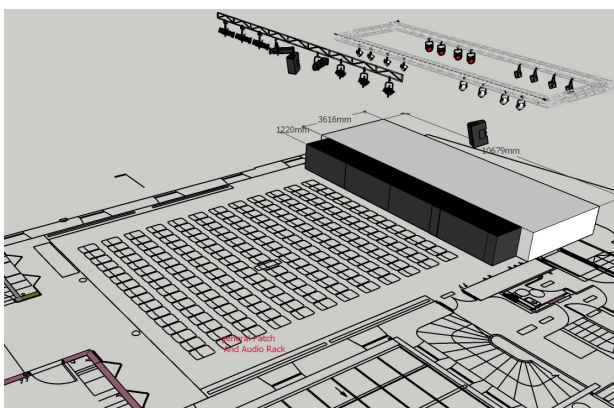
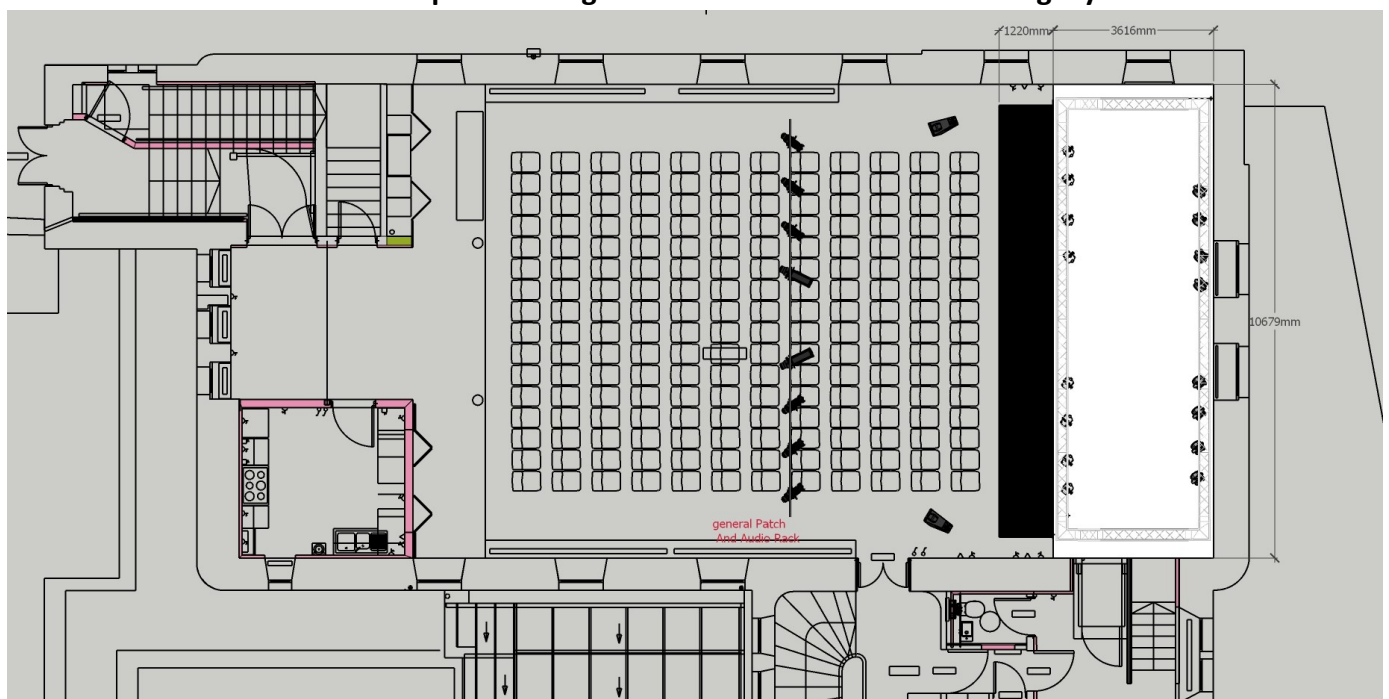

- Hall Capacity is 250 (seated or standing including balcony)
- The standard **Stage** is just over 10m wide and 3.6m deep
- With the extension the stage is just shy of 5m deep
- Treads to the auditorium floor are in stock and can be fitted
- Although in the 1st floor the hall has direct access via the rear fire escape via a short set of steps
- There is unloading parking directly outside the rear fire door
- DBH has a comprehensive professional staging, Lighting, Sound & AV package, please see overleaf
- Acoustics are excellent either for a full natural acoustic (all stage drapes removed) or excellently controlled for amplified events via comprehensive drapes.
- There is a single dressing room space with separate toilet facilities

There are additional workshop spaces that could be used as dressing rooms

Dunoon Burgh Hall

Dunoon Burgh Hall Trust

195 Argyll Street

Dunoon

PA23 7DD

Tel: 01369 701776

Email: info@dunoonburghhall.org.uk

Web: <https://www.dunoonburghhall.org.uk/>

Lighting & Sound Equipment

FOH Sound System	Number	Notes
d&b V7P Loudspeaker NL4	2	main FOH boxes
d&b V Subwoofer NL4	1	Sub, set on Hall floor not on stage
d&b E6 Loudspeaker NL4	3	Stage Infills
d&b 30D Amplifier		
Sound Desks & Digital Stage Boxes		
Midas M32R	1	main desk can be positioned at a mix position in the hall or from the control position at the balcony, happy to be used as a monitor desk if own desk is brought
Midas M32C	1	Conference/event and system only, not available (or appropriate) for performances
Midas DL16	1	Midas preamps sound great, fixed at side of stage with 2 x 8 way stage boxes
SD8 8 way stage box	2	8way stage boxes, 1 loose, ideal for drum kits etc, the 2nd fixed for House radio Mics
stage monitor system		8 way mixes are not a problem
Proel WD15A Active 2-way coaxial stage monitor 15" + 1" 900w Active	6	excellent active 15" coaxial low profile monitors
Behringer B215D	2	I know they say Behringer, but they are not bad sound ok and are loud, good drum fill
Mics and cabling		
Shure SM58	7	The Standard Dynamic Vocal Mic
Shure SM57	4	The Standard Dynamic instrument Mic
Sennheiser e614	2	Supercardioid Condenser
Sennheiser e604,	4	clip on dynamic drum mics
Sennheiser Pack e602-	1	Kick drum Mic, good on bas cabs as
MB MBNM 440	4	really nice true condenser mics (easily comparable to KM184)
BSS AR133 Active DI Box	6	The Standard DI box
Koenig & Meyer 25910 microphone stand, black Short Boom Stand	6	
Koenig & Meyer 210/2 microphone boom stand, black Tall 2 Piece Boom Stand	10	2 of these with telescopic booms
Audio Technica ES935ML6 MicroLine condenser gooseneck microphone	4	top table conference use and floor use for Choirs etc
Shure Microflex MX410R/S 10" Shock-Mounted Gooseneck, Supercardioid	2	lectern Mic
Radio Mics		
Shure QLXD24UK/SM86-K51 QLX-D Handheld System w. SM86 Head	2	excellent vocal mic
Shure QLXD14UK/85-K51 QLX-D Bodypack System w. Lavalier & Madonna style mics	2	can also provide cables to be used for instruments such as guitars
Lighting		
ETC Colo source 40 console	1	
ETC Colorsources Spot Light Engine, XLR, Black	8	
ETC Source Four Zoom 26"- Lens Tube, Black	6	
ETC Source Four Zoom 15"-30" Lens Tube, Black	2	
The ETC ColorSource PAR, Black	8	
Barndoors (Long) for the above	8	
Beam width Filter Kit for above	8	
Prolights StudiocobFC	8	

Dunoon Burgh Hall

Dunoon Burgh Hall Trust

195 Argyll Street

Dunoon

PA23 7DD

Tel: 01369 701776

Email: info@dunoonburghhall.org.uk

Web: <https://www.dunoonburghhall.org.uk/>

AV, rigging & Stage Equipment

Projection, AV & Cameras		
Screen International Major 400cm x 225cm, 16/9 format , Electric Screen, Matt White surface, 4 x 5cm Black Borders		
Panasonic Pt-RZ660 laser Projector 6000lumens SDI DLP with 1.8 ~ 2.4:1 lens		
Panasonic dle350 lens 3.6 ~ 5.4 :1 or 4m from 14.4 ~ 21.6m		
Blackmagic Design ATEM Television Studio HD		
Blackmagic Design Hyperdeck Studio Mini		
Blackmagic Design Web Presenter		
Datavideo Dace 70 cross convertor		
Datavideo ptc150 camera		
Datavideo rmc 180 controller		
Truss Rig		
Prolyte H30V 3M	8	
Two way corner section H30V	4	
250KG Prolyte 3phase direct drive motor with 6m chain		
Controller for above		
Doughty 9m Tab track kit. (with overlap and rope)		
Prolyte 0.3m ladder truss 3m section		
Drapes (all cloths DFR)		
LEGS X 2:- 4.5m high 2m wide (50% fullness) (Ties at top chain at bottom) Velvet (J&C Joel Purple VEL009 / VEL043*) lined with black Bolton twill.		
HEADER X 1:- 0.6m high x 8m (50% fullness) (Ties at top hemmed at bottom) Velvet (J&C Joel Purple VEL009 / VEL043*) lined with black bolton twill.		
TABS X 2;- 4m high x 5.5m (50% fullness) (piston hooks at top chain at bottom)Velvet (J&C Joel Purple VEL009 / VEL043*) lined with black bolton twill.		
Black Wool Serge Backdrop x 1;- 4.5m high 10m wide (50% fullness) (Ties at top chain at bottom)		
Filled gauze Cyc X 1;- 4.4m high 9m wide (0% fullness) (Ties at top pocket at bottom)		
Staging		
LiteDeck 8ft x 4ft Stage Unit (with ply deck) to meet 1100mm high stage and 570mm high stage	4	
LITEDECK 5 MODULAR STEP UNIT inc adjustable handrails		
Stage Flooring		
Double sided Harlequin stage floor		